

Handling information

for KERAFIX® Flexlit and KERAFIX® 2000 Classic glazing tape with self-adhesive on one side

Compared to other fixing systems, the benefit of glazing tapes that are self-adhesive on one side is that they are quicker, cleaner and more economical to apply.

To utilise the benefits of this system to the greatest extent possible, please follow the handling instructions listed here.

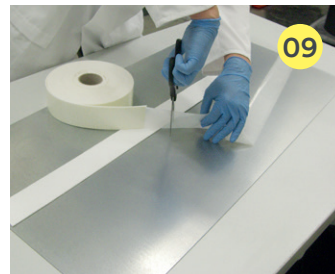
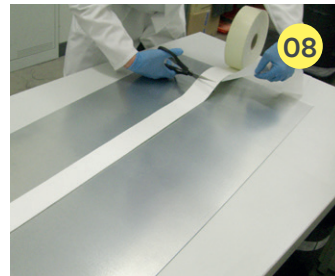
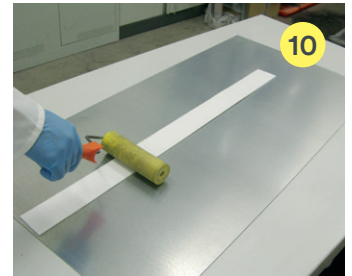
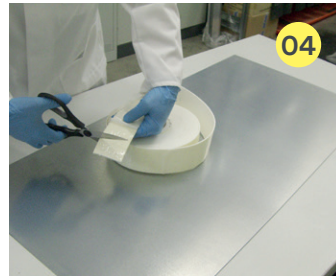
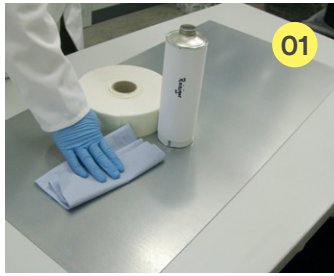

01. Clean and dry the work surface.
02. Release the peeling aid at an acute angle (around 180°).
03. Use the peeling aid to lift the separating film slightly.
04. Trim the starting section of the tape including the covered adhesive.
05. Position the glazing tape precisely (with the side with the separating film facing downwards).
06. Pull off the separating film while holding it down flat.
07. Press the glazing tape down slightly during application.
08. Cut the glazing tape to length without damaging the separating film (pull the separating film back far enough to do so).
09. Trim the excess (exposed) separating film so that a manageable piece remains on the roll and can be used as a peeling aid for the next application.
10. Press the glazing tape on evenly using a hard foam roller.
11. Wait until the final adhesive strength is reached.

While working with self-adhesive glazing tapes, avoid lifting off the separating film, dirtying the adhesive area or subjecting the tapes to unnecessary strain (tension/compression) under all circumstances. The final adhesive strength is achieved no earlier than 24 hours after application.

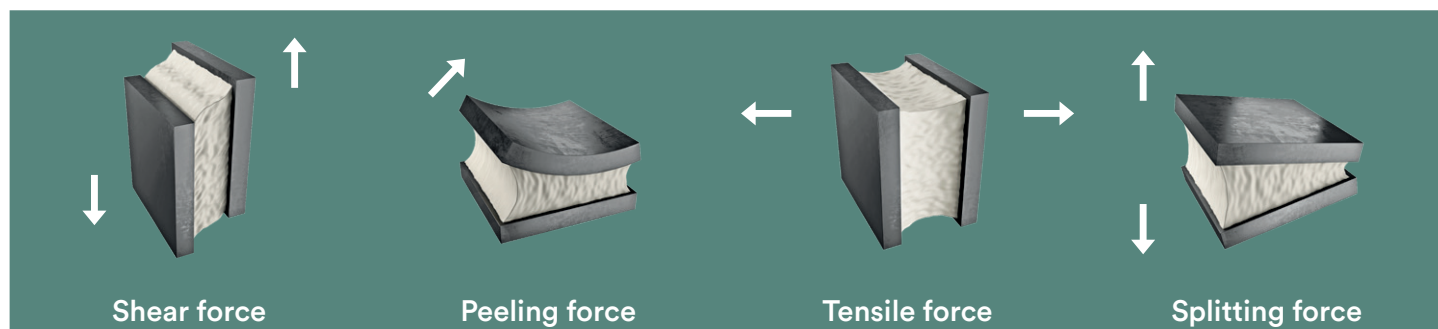

Making a new peeling aid

If the glazing tape becomes dirty or the separating film is accidentally cut through, you can make a peeling aid as follows:

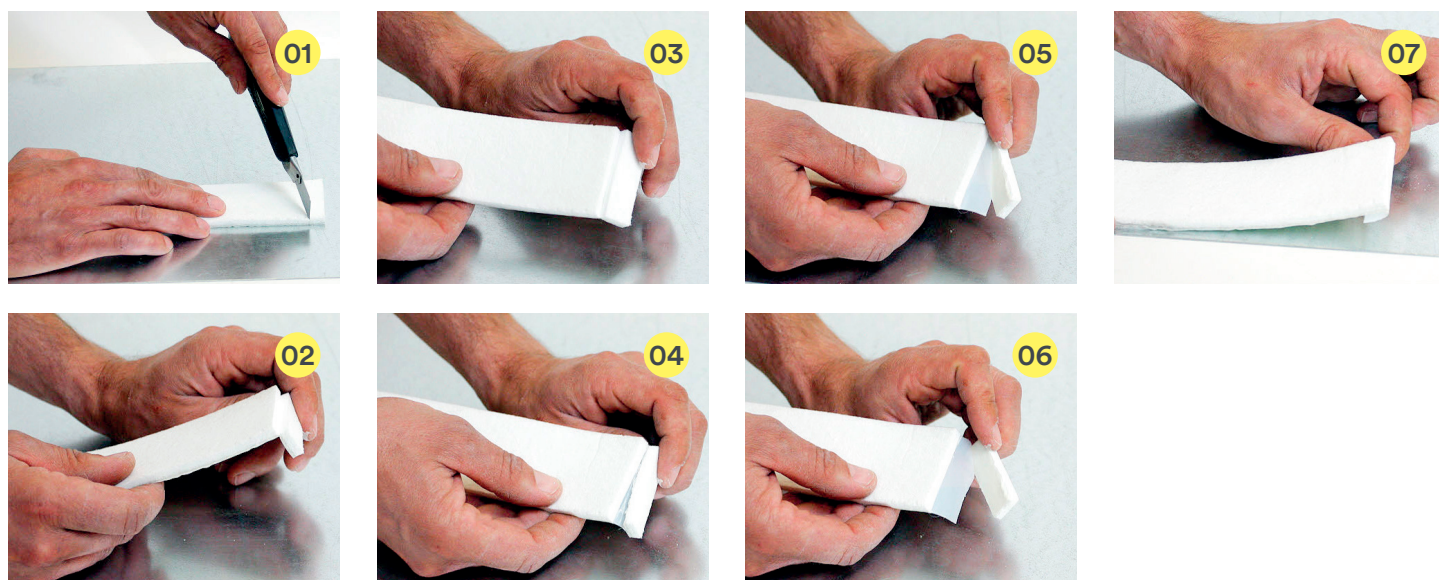

01. Position the glazing tape on a surface with the separating film facing downwards; use a box cutter (or a similar cutting tool) to detach a manageable strip (including its adhesive layer) from the rest of the glazing tape. Ensure the separating film remains intact during cutting.
02. Fold the section of the glazing tape back at the cutting point.
03. Check the cut.
04. Remove the section of glazing tape from the rest of the glazing tape.
05. Remove the section of glazing tape from the separating film.
06. Leave the piece of separating film that is now exposed on the roll.
07. The exposed piece of separating film serves as the new peeling aid.



View as video