

Drawing : open to 180°

3D-adjustable concealed hinge for recessed frame installations designed to be mortised into a recessed frame to provide up to a 15mm throw. "Design" model available with magnetic cover plates without visible fasteners.

Max Door Weight (per pair): **176 lbs. (80kg)**

Min Door Thickness: **1-3/4" (45mm)**

Height: **7.87" (200mm)**

Widths: Frame **1.26" (32mm)** / Door **1.30" (33mm)**

For doors with frames recessed up to **.59" (15mm)** from the face of the door leaf.

Accessories: Casing frame fixing plates and metal frame receivers available.

Finishes: See page 24 for available finishes.

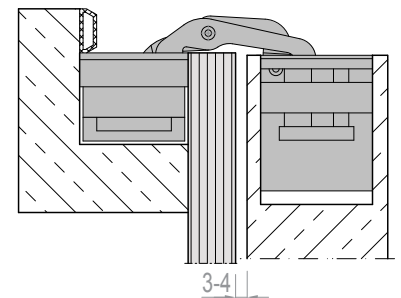
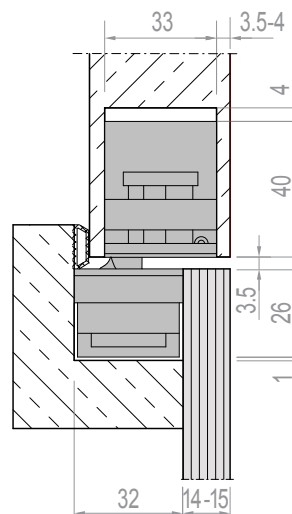

Section of Wood Frame-Door Installation